



PRAMETTE FOR ELEMENT™ STROLLER



Scan for instructional video



Escanee para obtener
instrucciones en español

Model # ZY025
A011-R3 11/2022

IMPORTANT - READ CAREFULLY AND KEEP FOR FUTURE REFERENCE

WARNING

Failure to follow these warnings and instructions could result in serious injury or death. Do not use this pramette if you cannot exactly follow the instructions that come with it. Make sure pramette is fully assembled and secure before use. Do not use the pramette if it is damaged or broken. ADULT ASSEMBLY REQUIRED.

IMPORTANT SAFETY INFORMATION:

- Stay near and watch baby during use. This pramette is not safe for sleep when detached from the stroller. If baby falls asleep, move baby as soon as possible to a firm, flat surface such as a crib or bassinet.
- Only use on a firm, horizontal level and dry surface.
- Do not let other children play unattended near the pramette.
- Do not place the pramette near open fire or other source of strong heat.
- Pramette is not intended for use as an infant restraint device in motor vehicles. **NEVER** use this pramette as a means to transport an infant in a motor vehicle.
- Inspect the handles and the bottom of the pramette regularly for signs of damage and wear. Do not use if any part of the pramette is broken, torn or missing.
- **FALL HAZARD**
 - To help prevent falls, do not use pramette with a child who can roll over or push up on hands and knees or who has reached 20 lb (9kg), whichever comes first.
 - Child's activity can move pramette. **NEVER** place pramette on counter tops, tables, or any other elevated surface.
 - Before carrying or lifting, make sure that the handle is in the correct carry position.
- **SUFFOCATION HAZARD:** Infant pramette can roll over on soft surfaces and suffocate child. **NEVER** place carrier on beds, sofas, or other soft surfaces.
- **STRANGULATION HAZARDS:** Do not place any cord, strap or similar item in or near this pramette that could become wrapped around a child's neck. Strings can cause strangulation! Do not place items with a string around a child's neck, such a hood strings or pacifier cords. Do not suspend strings over pramette or attach strings to toys. Do not place this pramette near a window or patio door where a child could reach the cord of a blind or curtain and be strangled.

⚠️ WARNING

- Use only the pad or replacement pad supplied by Kolcraft with this pramette.
- **NEVER** add a pillow, comforter, or additional pads to this pramette for padding.
- Head of child in the pramette should never be lower than the body of child.
- Do not use the pramette without the inner liner attached.
- Do not allow any fabric to cover child's nose or mouth.
- Use only the sheet that is provided with the pad for the pramette.
- Only use replacement parts supplied by Kolcraft.
- Never leave child unattended.

CARE & MAINTENANCE

MATTRESS COVER

- Hand wash only, use only non-chlorine bleach when needed.
- Line dry.
- Warm iron as needed.

INNER LINER

- Hand wash only, use only non-chlorine bleach when needed.
- Line dry.

PRAMETTE FRAME, CANOPY & BOOT COVER

- Clean with a damp cloth and wipe dry.

PARTS LIST

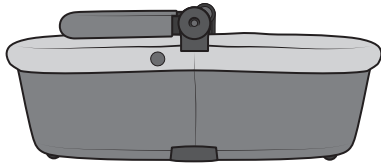

PRAMETTE FRAME



SCREWS (4)

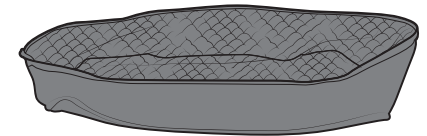

INNER LINER

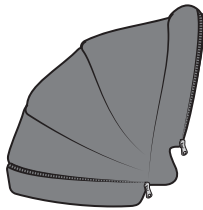

CANOPY

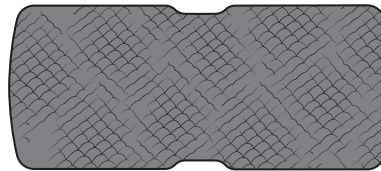

MATTRESS COVER & PAD

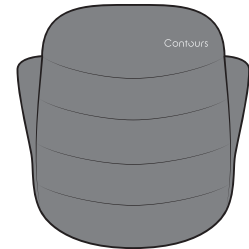

BOOT COVER

ASSEMBLING PRAMETTE

1-1

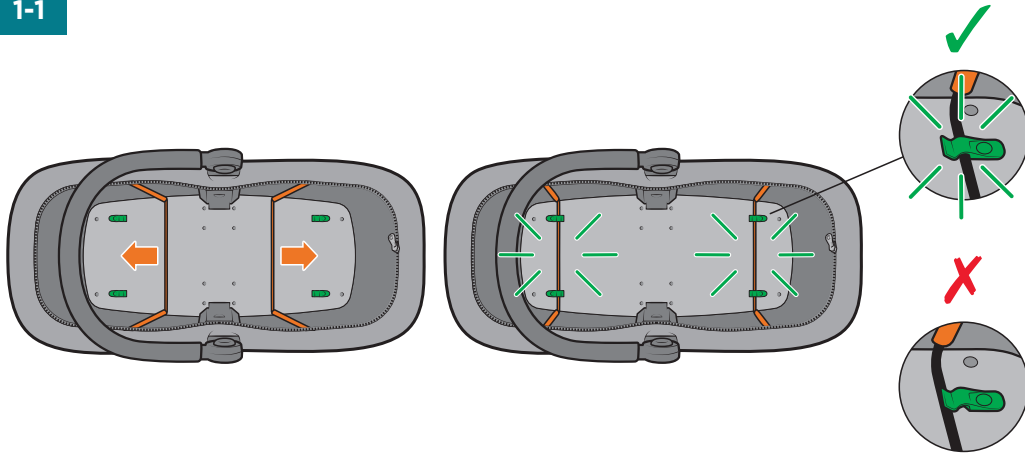

1-2

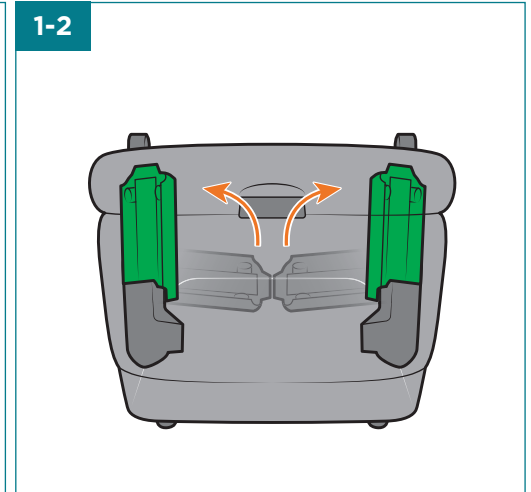

1-3 x4

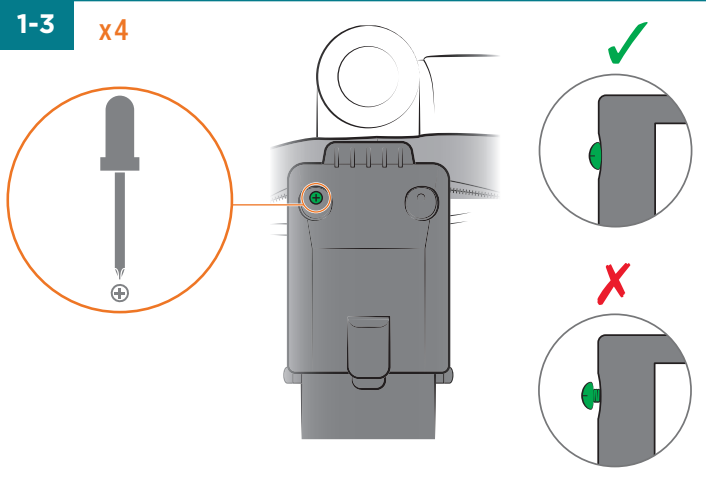

1-4 x2

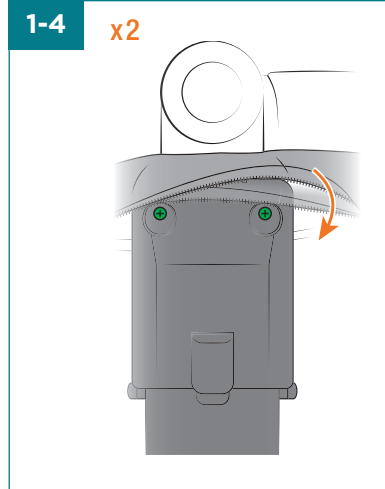

1-5

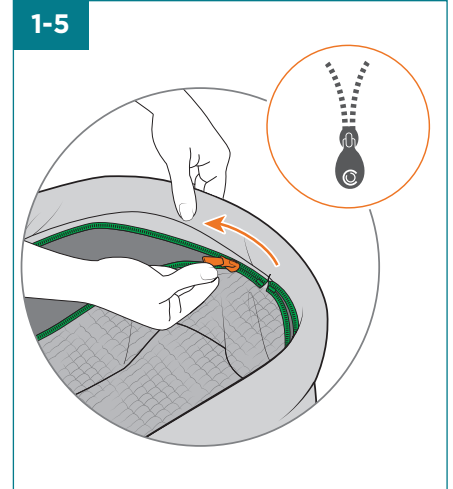

ATTACHING CANOPY

2-1

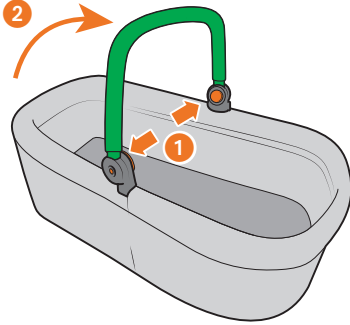

2-2

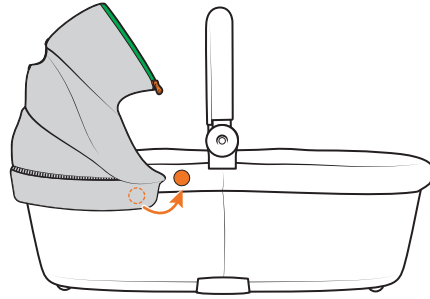

2-3

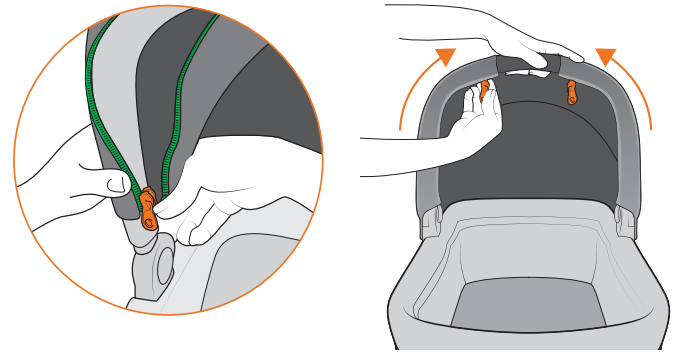

2-4 x4

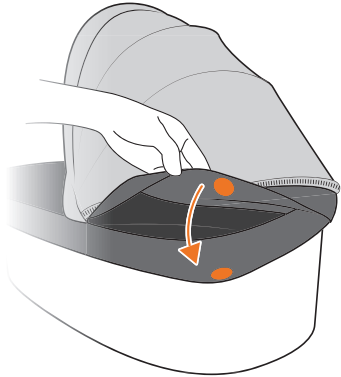

ADDITIONAL AIR FLOW

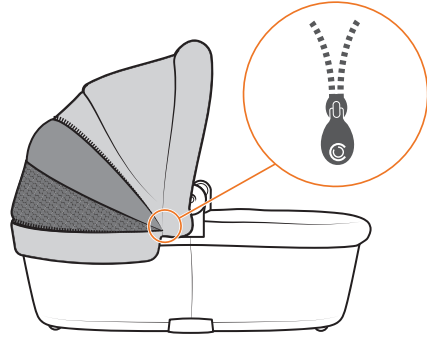

INSERTING MATTRESS PAD

3-1

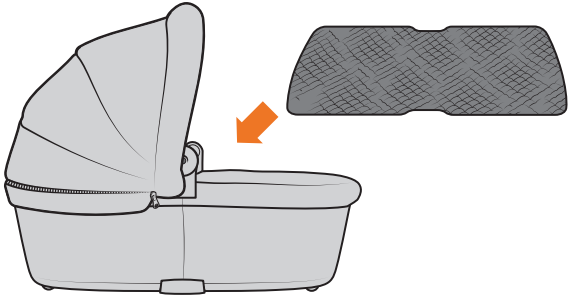

ATTACHING BOOT COVER

4-1

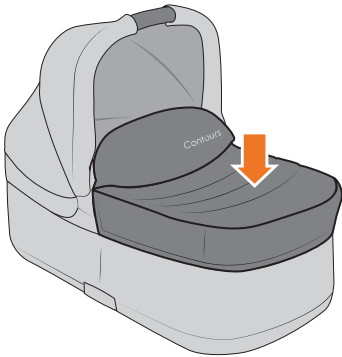

ATTACHING PRAMETTE TO STROLLER

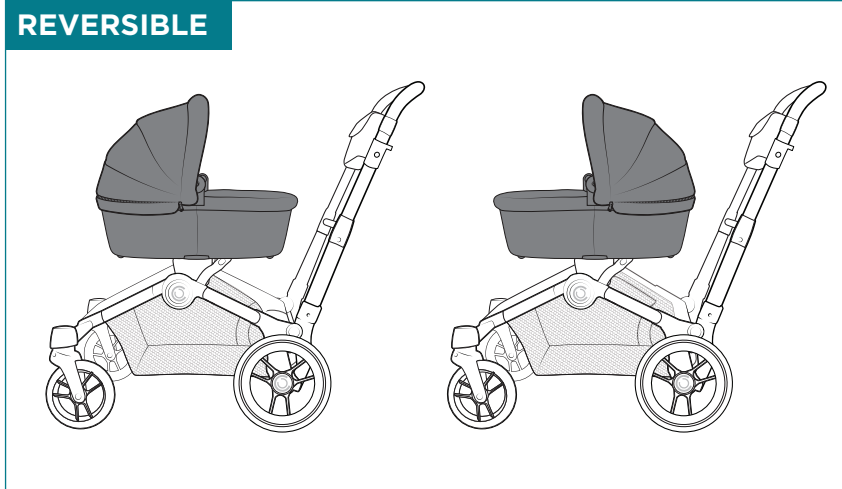
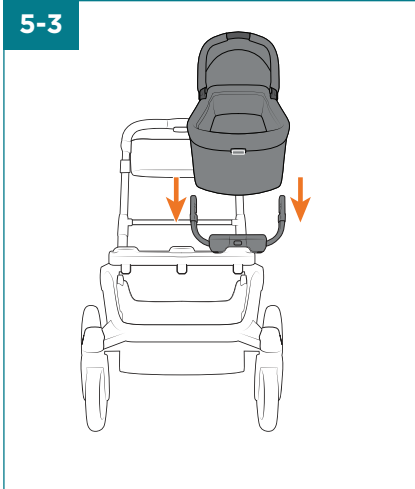
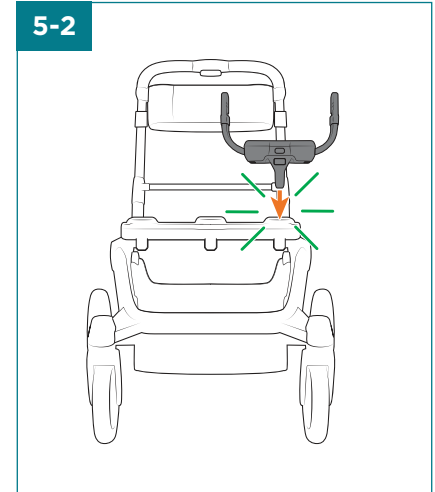
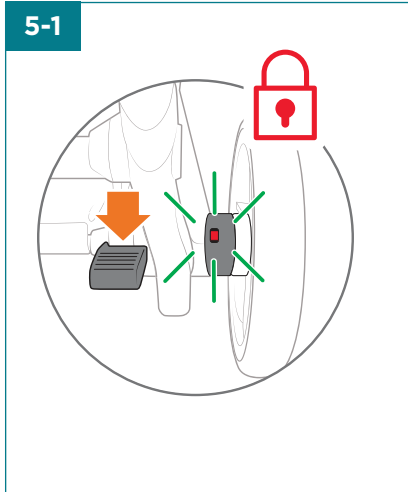
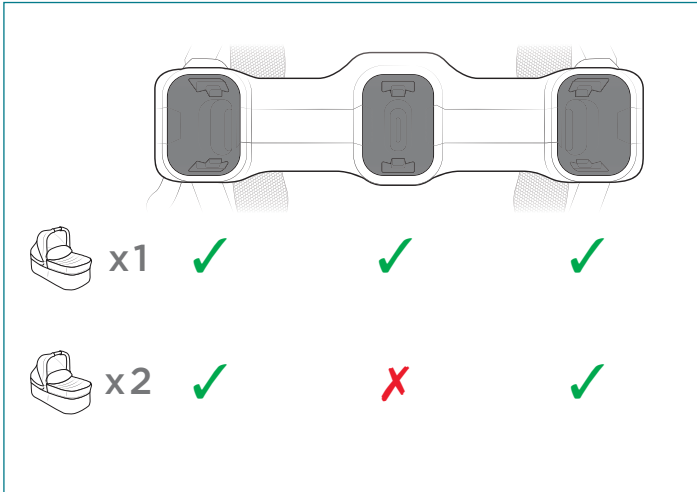

REMOVING PRAMETTE FROM STROLLER

6-1

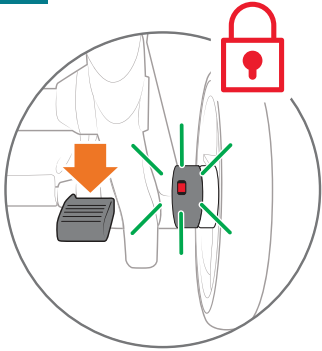

6-2

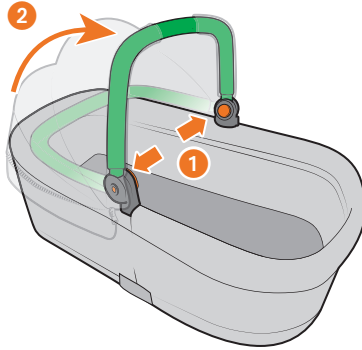

6-3

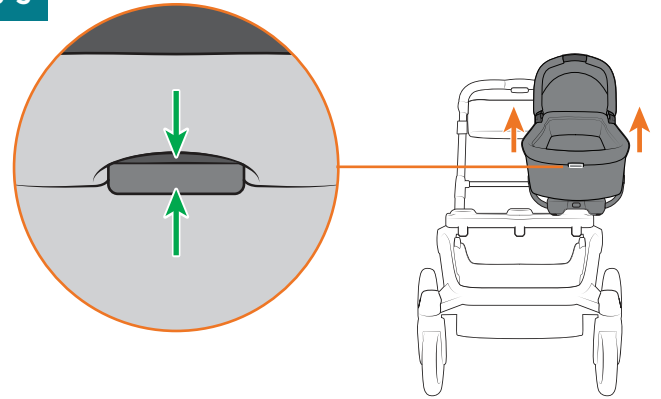

REMOVING CANOPY

7-1

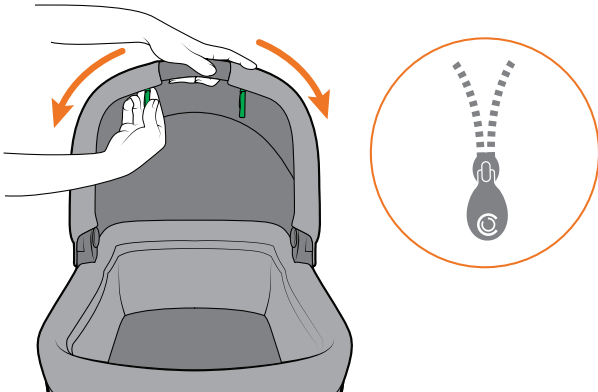

7-2

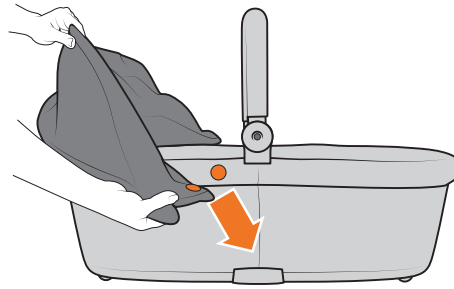

Contours® - United States
1100 W Monroe St
Chicago, IL 60607

1-888-226-4469
customerservice@contoursbaby.com