

# Contours Explore™

## 2-IN-1 PORTABLE BOOSTER SEAT AND DIAPER BAG



Love us . . . leave a review!



Scan for instructional video

Model # : ZN008  
F018-R1 01/2021

# IMPORTANT - READ CAREFULLY AND KEEP FOR FUTURE REFERENCE

## WARNING

Your child's safety depends on you. Proper product use cannot be assured unless you follow these instructions.

- Read all instructions BEFORE assembly and use of the booster seat.

Children have suffered **head injuries**, including skull fractures, **after falling** with or from booster seats.

- This product is intended for children able to sit unaided (minimum 9 months) and up to 60 months or a maximum weight of 60 lb (27.2 kg).
- Use this product only for children capable of sitting upright unassisted.
- Only use booster with a chair with a seat back height of at least 13.25 in (34 cm), a seat width of at least 12.5 in (32 cm), and a seat depth of at least 13 in (33 cm).
- Check that booster seat is **securely attached** to adult chair before each use.
- Always use the chair attachment system and ensure it is correctly fitted before use.
- Always check the security and the stability of the product on the adult chair before use.
- **Always use restraints** until child is able to get in and out of booster seat without help. Adjust to **fit Snugly**.
- For children that are able to get in and out of the booster without help, keep the restraints unsecured and seat back in the down position.
- **Never** allow child to **push away from table**.
- **Never lift** and **carry** child in booster seat.
- **Stay near** and **watch** your child during use. Never leave the child unattended.
- Prevent serious injury or death. Do not use in motor vehicles.
- Do not use on chairs where straps cannot be fully tightened.
- Do not use this product on stools or benches.
- Ensure that the adult chair with the chair mounted seat is placed in a position where the child is not able to use its feet to push against the table or any other structure as this can cause the tip over of the adult chair supporting the chair mounted seat.
- Before each use place backpack carry straps in their storage pocket.
- Do not use chair mounted seat if any part is broken, torn or missing.
- Do not use accessories or replacement parts other than those approved by the manufacturer.
- 60 lb maximum weight; Do not use as a step stool.

### CARE & MAINTENANCE

- Wipe clean with mild soap and water.
- For Machine wash: Remove base, buckle all buckles, zipper down (close) seat back. Machine wash cold, gentle. Line Dry. Do not iron. Do not bleach.
- Stop using this booster if parts are missing or damaged.
- If problems are detected, call consumer services 1-800-453-7673

Contours® - North America  
1100 W Monroe St  
Chicago, IL 60607

1-888-226-4469  
customerservice@contoursbaby.com

Contours® - Europe  
Windmolen 22  
7609 NN Almelo  
The Netherlands

+31 548 659096 / europe@contoursbaby.com

# PARTS LIST

1 Shoulder Strap - Used as the seat bottom strap

2 Seat Back

3 Restraint System

4 Seat Back Strap

5 Strap Clips

7 Backpack Straps

6 Slip-Resistant Grips

8 Back Pocket

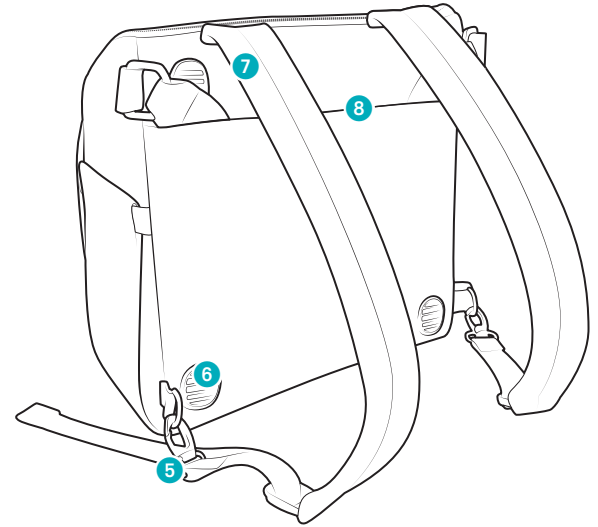
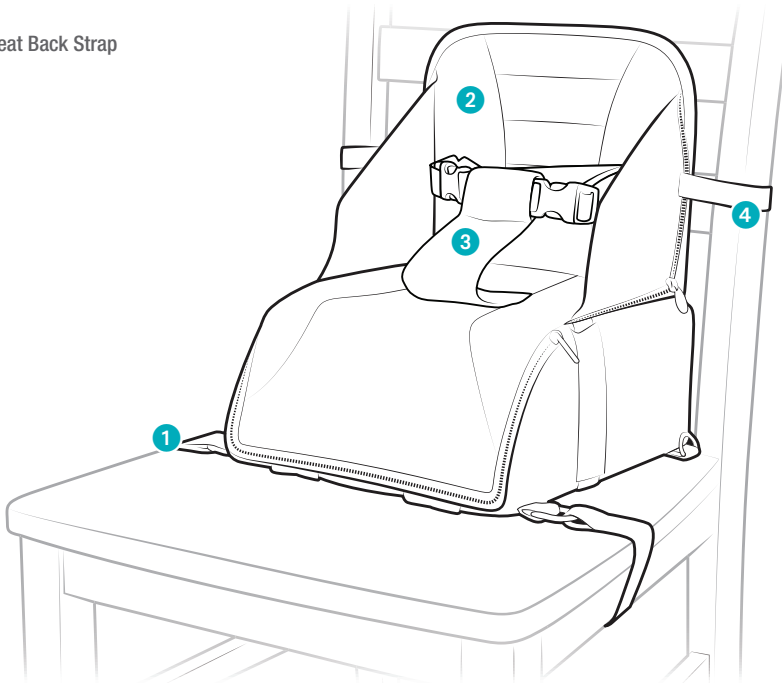

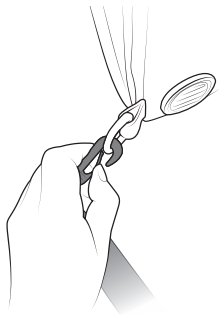

1

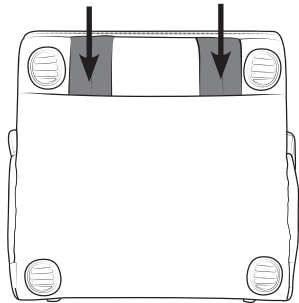

1. Unhook backpack straps and place backpack straps in their storage pocket.

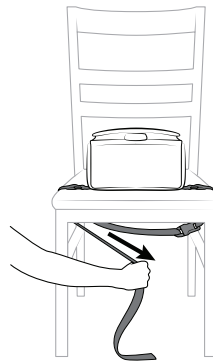

2 - 4

2. Place bag on chair as shown. Unlatch buckle on shoulder strap.

3. Ensure both portions of the shoulder strap are behind the front legs of the chair and fasten the buckle of the shoulder strap.

4. Tighten strap & continue to pull until shoulder strap is fastened against the bottom of the chair.

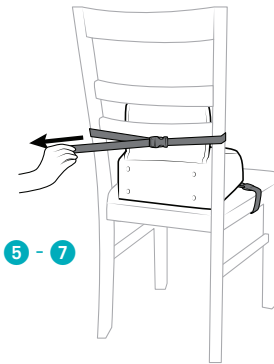

5 - 7

5. Unzip the two seat back zippers and raise seat back.

6. Fasten the buckle of the seat back strap behind the chair's back.

7. Booster should not move freely on the chair once tightened. If the booster moves, re-tighten until secure or do not use on that chair.

8. Place crotch strap between child's legs. Adjust restraint system to fit snugly around child's waist.